

MEN'S & WOMEN'S



GARDEN CLUB

OF MINNEAPOLIS

April 2019

The Garden Spray

Vol. 77, No. 4

IN THIS ISSUE

Meeting Preview

From the Editors

Plant Sale News

FFF Floral Design Theme

Volunteers Needed

Lyndale Garden/Mixed Border Garden

Lyndale Garden/Native & Shade Gardens

Deane Fund Grants

Tour News

Marketing & Publicity

More Spring Events

Membership Corner

Board Meeting Highlights
Treasurer's Snapshot
2019 Meeting & Event Calendar
2019 Officers & Directors

April 9 Meeting Preview

LANDSCAPE DESIGN WITH MATT BROOKS



This month's guest speaker is Matt Brooks, landscape horticulture instructor at Dakota County Technical College.

Tuesday, April 9

Meeting location:
Lakewood Cemetery Mausoleum

Menu

6:00 Social Time
6:15 Dinner
7:00 Business Meeting
7:30 Program

Penne Pasta & Meatballs
Green Beans
Salad
Bread

- Permanent reservations are in effect.
- Dinner is \$13.00.
- Reservations or cancellations are required no later than Friday, April 5.
- Email Sharla Aasang at resmwgcm@juno.com, or call (612) 623-9341 and leave a message.
- Note: for last-minute cancellations, contact Sharla. If she can sell it, you won't be billed.

From the Editors

Nancy Felice, Tom McKusick, Co-editors

This month, we're giving over the editor's spot to this timely message we received from Paul Waytz.



"Greetings from New Zealand. I had planned on sending these photos a couple of days ago but was delayed. Today, I send them from Christchurch, less than 24 hours after the horrific and senseless tragedy that



occurred here.

"Originally, my intent was to send a breath of fresh air to fellow gardeners. Maybe now, it's still a thought of eventual spring but even more a chance to pause and reflect and consider. Hug your friends and family and even those you barely know. "

-- *Paul Waytz*

Plant Sale Committee

Gary Geister, Chair

IT'S ALMOST HERE -- THE ANNUAL MWGCM PLANT SALE

Tuesday, May 7
St. Mary's Greek Orthodox Church
3450 Irving Avenue South
Minneapolis

Noon - 6:30 p.m.

A Sample of New Plants Available This Year

On March 28, I received the shipment of plants from Bluebird Nursery. For the third year in a row they asked if I had a forklift available to help unload the pallet of plants to be delivered. My question is, would the board approve the purchase of a forklift? It would be used every year for about three minutes.

Opening the pallet of plants is always a lot of fun and full of surprises. All the plants looked great especially the Dragon Wing begonia. It was loaded with blooms already as I was taking it out of the box. The Acalypha Wilkesiana was fantastic. It is ready for the plant sale now.

Also new this year, we will have a large selection of potted containers, baskets of shade or sun plants, and containers of succulents plus a variety of herbs (same as last year) in containers. Any of these would make a great Mother's Day gift.

ANNUALS



Acalypha Wilkesiana

Acalypha Wilkesiana - a great accent foliage plant with shiny coppery brown and green leaves

Begonia - Tophat™, a big, big begonia, red or white

Marigold - 'Strawberry Blonde'

Petunia - 'Constellation Gemini'



'Strawberry Blonde'

Zinnias - the FFF flower of the year:
'Benary's Salmon Rose'
'Envy'
'Queen Red Lime'
'Zinderella Purple'



'Constellation Gemini'

PERENNIALS

Astilbe - 'Amber Moon'

Campanula - 'Dickson's Gold'

Dianthus - 'Apple Blossom Burst'

Echinacea - 'Green Twister'

Gallardia - 'Mesa Red'



'Dickson's Gold'

Iris - 'Immortality' A
reblooming iris

Salvia - 'Violet Profusion'

-- Gary Geister



'Green Twister'

**Annual 4-packs available
at the sale**

Along with the interesting specialty annuals and perennials that Gary is coordinating, we have ordered 50+ flats of bedding annuals from a new source. Many annual flowers from ageratum to zinnias will be available at competitive prices. Mary Maynard will have the list of annuals we've ordered at the April club meeting if you'd like to see what's coming. Shop with us first!

-- Mary Maynard

HOSTAS AT THIS YEAR'S SALE

We have an excellent selection of small, medium, and large hostas including two more mini hostas from the mouse ears group. We again have ten each of The American Hosta Growers Association (AHGA), Hosta of the Year, H. 'Lakeside Paisley Print.'

This year for the first time, we have hostas from Rush Creek Growers, a local source. Use the links to the nurseries for more information.

In addition to these there will be other hostas of various sizes, colors, shapes and quantities. If anyone has hostas to donate for the sale, please contact [Steve Shubick](#).

Prices for hostas will range from \$6.00 to \$16.00.

2019 Hosta of the Year H. 'Lakeside Paisley Print'



Medium 10"H x 20" W. This stunning hosta produces heart-shaped leaves with very wide, wavy, green margins. The narrow, creamy white markings in the center of the leaves shoot out from the

cream-colored petioles in a feathery pattern. Its thick leaves make the perfect background for the cream scapes that carry the light lavender flowers in midsummer. This hosta is good grower with great substance and is highly sought after. It stands out in any garden.



We will have five each of these hostas from [Naylor Creek Hosta Nursery](#):

H. 'Bedazzled, Small 6" H x 20" W. Small clump of blue-green leaves framed by a wide yellow-gold border. Flower lavender. Hybridized by Don Dean, a local hosta hybridizer.

H. 'Hands Up', Small, 8" H x 12" W. True tetraploid of H. 'Praying Hands' with lots of great attributes. Very thick, almost rubber-like leaves and a creamy-yellow to white border. Clump will be topped with lavender flowers. Good in a pot.

H. 'Fire Island', Medium 15" H x 24" W. Requested again by members. Wide, stunning red petioles hold bright yellow to greenish-yellow, wavy leaves. The medium sized mound has slightly wavy, corrugated leaves with deep maroon-red petioles.

H. 'First Frost', Medium 14" H x 36" W. A medium size mound with thick foliage. In spring leaves are blue-green and yellow turning to dark green and white in midsummer. 2010 AHGA Hosta of the Year.

H. 'Paisley Border' Medium 12" H x 30" W. The reverse variegation of 'Lakeside Paisley Print'--dark green leaves have a fairly wide creamy-white border. Great substance and lots of style.

H. 'Secret Treasure' Medium, 12" H x 25" W. H. 'One Man's Treasure' has been one of our favorites. H. 'Secret Treasure' with a nice wide white border, shiny dark green leaves and red petioles that show color well up into the leaf.

H. 'Silver Bay', Medium 14" H x 38" W. Intense silver-blue leaves make a flat mound about 14" high. Leaves are quite round with some cupping and good corrugation. This Hosta should rank near the top of any list of best blue hostas.

H. "Poker" Medium/Large, 14" H x 24" W. Fast-growing cultivar with slightly blue-green foliage. Leaves are broadly ovate, lightly corrugated and dull on top.

H. 'Guacamole', Large, 24" H x 54" W. Broadly ovate foliage has a chartreuse center that turns brighter as the season progresses. AHGA 2002 Hosta of the Year.

H. 'Paradigm' Large, 22"H x 48" W. Blue-green with a cream margin and lavender flowers. 2007 AHGA Hosta of the Year.

10 each of these hostas will come from [Rush Creek Growers](#):

H. 'Sun Mouse', Mini, 6" H x 18" W. A gold version of 'Blue Mouse Ears.'

H. 'Mighty Mouse' Mini 6" H x 19" W. Another very good sport from H. 'Blue Mouse Ears.' Starts out blue-green with a yellow border and later turns to grey-green with a white border.

H. 'Curly Fries', Mini 5" H x 16" W. Gold, mounding, highly ruffled narrow leaves emerge yellow and fade to near white. Vigorous grower. 2016 AHGA Hosta of the Year.

H. 'Rainbow's End', Small 10" H x 21" W. Extreme variegation and shiny leaves. The leaves with a bright yellow center and dark green margins. No two leaves look the same. In late summer, showy red scapes carry the dark lavender, tubular flowers.

H. 'Pocket Full of Sunshine' Medium, 12" H x 20" W. Grows quickly into a compact clump of thick cupped yellow leaves framed with broad deep green borders. Leaves are thick and heavily puckered.

H. 'Waterslide' Medium, 12" - 15" H x 30" W. Thick blue leaves that are tightly rolled. Leaves look like water splashing in the shade garden and hold their blue color well. This one is going to be an all-time favorite.

H. 'Island Breeze' Medium, 12" H x 18" W. Improved sport of 'Paradise Island' with wider margins and better leaf substance. Wide, dark green margins stand in sharp contrast to the bright yellow centers in early spring.

H. 'Lakeside Paisley Print' Medium 10"H x 20" W. 2019 Hosta of the Year. See details above.

-- *Steve Shubick*

VOLUNTEERS STILL NEEDED

Thanks to all who have already signed up to help with the plant sale. We are still looking for a few more people to help during the sale, especially **cashiers, checkout**

assistants and sales assistants on the floor. Please email [Mary Maynard](mailto:Mary_Maynard) or call (952) 926-7506 if you can help out. No experience necessary!

Flower, Food & Foto Show

Judy Berglund, Chair

THIS YEAR'S FLORAL DESIGN THEME: "SONG TITLES WE LOVE"

Announcing the 2019 Floral Design Division Classes for the Flower, Food, and Foto Show on August 10 and 11. The design classes are as follows:

1. "It's a Small World" -- Miniature design less than 6"x6"x6"
2. "By the Light of the Silvery Moon" -
- Floral design using white or cool colored blooms.
3. "Great Balls of Fire" -- Floral design using red or warm colored blooms.
4. "It Might as Well be Spring" -- Floral design using pastel colored blooms.
5. "Tapestry" -- Floral design using earth colors/natural colored blooms.
6. "Stairway to Heaven" -- A tall floral design.



The materials used in the designs need to be "garden grown" but do not need to all come from your garden. The materials you might find at a farmer's market are often garden grown by local farmers.

There are two classes for floral design:

Amateur - open to all who have won five or fewer first place awards in the design division of the flower show.

Advanced - open to all.

This division historically has had few entries, but last year's response was wonderful. So, get your creative juices flowing and keep up the great work with floral arrangements in this year's FFF Show.

VOLUNTEER IN PUBLIC GARDENS

The MWGCM has five community service projects and invites members to join in. Three of the projects are at Lyndale Park in Minneapolis. The club now has three gardens along the north side of Roseway Road that border with Lakewood Cemetery. There is a Mixed Border Garden, a Native & Shade Garden, and a Winter Interest Garden.

The Arbor Day Committee is planning to add crab apple trees to the Lyndale Park's Crabapple Collection.

Two Deane Grant funded projects will be starting in 2019 also. One is a new garden at Lake Harriet near the bandshell. Another is refurbishing the Minneapolis Veteran's Day Center Courtyard.

Here is a list of members who lead these projects and their proposed garden work day schedules. Contact them for more information or to offer your help. Let's share our gardening gifts with our community.

[Kay Wolfe](#), Lyndale Park Mixed Border Garden.

Work days Tuesday and Saturday morning starting in April.

[Kirky Otto](#) and [Carol Schreier](#), Lyndale Park Native & Shade Gardens.

Work days Wednesday mornings.

[Robert Kean](#), Lyndale Park Winter Interest Border and Arbor Day.

[Paul Waytz](#), Lake Harriet Garden.

Ground prep in April and planting in May. Probably Saturdays.

[Steve Shubick](#), Veterans Home Garden.

VOLUNTEER FOR UPCOMING EVENTS INVOLVING MWGCM

We need of volunteers for upcoming events involving MWGCM. Email [Becky DeLaCruz](#) or call (727) 644-0176 if you would be willing to take part in any of these events.

Dundee Nursery Spring Expo, Saturday April 13

2 - 4 volunteers needed total (1 or 2 per shift) to staff the MWGCM table in the greenhouse.

Two shifts available: 9 a.m. to 12:30 p.m. and 12:30 to 4 p.m.

Responsibilities: pass out membership brochures, 2019 bookmarks and "Save the Date" cards for the MWGCM Plant Sale and Public Tours. Last shift would need to take club supplies home with them temporarily.

Benefits: 20% off merchandise coupon and free lunch.

Friends Plant Sale, Friday and Saturday May 10 & 11

4 - 8 volunteers needed total [1 or 2 (preferred) per shift)] to staff the MWGCM table in the Garden Fair area.

Friday shifts: 9 a.m. - Noon and Noon - 3 p.m.

Saturday shifts: 10 a.m. - 12:30 p.m. and 12:30 - 3 p.m.

Responsibilities: pass out membership brochures and 2019 bookmarks and promote the July 20 MWGCM Public Tour by passing out "Save the Date" cards and selling tickets. Last shift would need to take club supplies home with them temporarily.

Benefits: shop the Friends Plant Sale early on Thursday evening (6 - 9 p.m.) during the pre-sale.

Lyndale Park Gardens/Mixed Border Garden

Kay Wolfe, Chair

TIM ROSENER'S FLOWER PAINTINGS



For the last five years, MWGCM member Tim Rosener has created art in flowers at the Lyndale Park Garden. Tim, a retired MPRB Lyndale Park Rose Garden gardener, decided to create "flower carpet" designs in the Mixed Border Garden. As of 2019, Tim has "retired" from this retirement job. We look back fondly on his designs and give him a huge "thank you" for all the work that it took to make them. Everyone would ask: "What is Tim designing this year?" And I would always have to say: "We won't know until

he plants it!"



2014

MWGCM letters in gold sedum rupestre on a background of burgundy alternanthera. Paul Aarestad at Lakewood provided the annuals and the forms for the letters. Even Google maps had a satellite picture of the border.

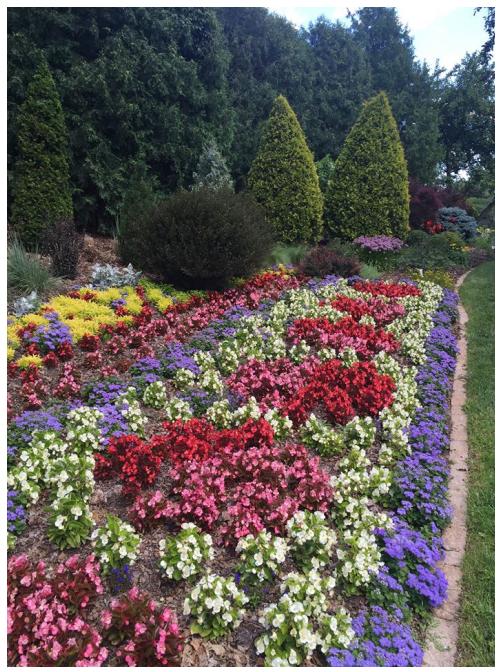

2015

The crown logo from "Game of Thrones" TV series. Four colors of begonias, ageratum, sedum, and some miscellaneous. So very colorful.



2016

U.S. Flag for Election Year surrounded by exploding fireworks. Begonias, alyssum, and miscellaneous annuals and perennials.



2017

"75" and "MWGCM" for the club's 75th anniversary.



2018

Mosaic with begonias, kale, salvia, dusty miller, and castor bean

Thanks Tim! We will miss your "Flower Carpets."

Lyndale Park Gardens/Native & Shade Gardens

Kirky Otto, Carol Schreier, Co-chairs



In what is becoming an annual tradition, members of the Native & Shade Garden Committee met for breakfast before touring the "Galleria Garden Party" with flowers by Bachman's.

This year we were treated to a surprise visit by Dale Bachman who took time out of his busy "retirement" schedule to give us the

inside scoop on the show and what's happening at Bachman's. If you haven't seen

the show yet, you still have time before the final day, Sunday, April 7.

-- Nancy Felice

Thinking ahead, the members of our volunteer gardeners at Lyndale Park (Lake Harriet) are looking forward to hosting **"An Evening in the Garden"** for MWGCM members, late this summer. Wednesday, August 21 is the date (with August 22 as the rain date). The evening will be casual, and refreshments will be served. Save the date and watch for details this summer. See you there!

-- Kirky Otto

Deane Fund Grants Update

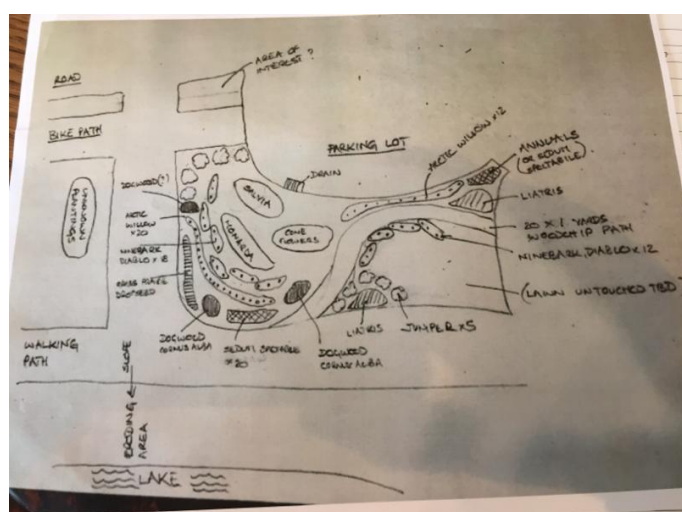

It's officially spring, and I thought I'd send out the tentative plan for "the humps" at Lake Harriet (we need to find a better name). It may be hard to determine the species from this plan, but it will mainly be Diabolito® Ninebark, Sea of Gold® Juniper, Arctic willow, Neon Burst™ Dogwood, and sporobolus (prairie dropseed). Perennials might be subject to change and certainly subject to what's left in the grant (\$2,500).

I hope to have the city start digging up the area toward the end of April and start planting shortly thereafter, but much depends on weather and other timetables. I'll keep you posted on dates, etc. Feel free to [contact me](#) if you have questions.

As always, thanks for your willingness to be part of this.

-- Paul Waytz

Tour Committee

Robert Kean, Chair

SUMMER TOUR DATES ANNOUNCED

Club Progressive Tour

Tuesday Evening, June 25

We'll visit two member gardens while enjoying appetizers, beverages, and dessert.

Public Tour

Saturday July 20, 9:00 a.m. to 4:00 p.m.

Tour six excellent gardens in the west metro, with options to either drive yourself or ride by motor coach.

Additional details will be published in future editions of the *Garden Spray*.

Marketing & Publicity Committee

Becky DeLaCruz, Chair

The basic goal of the M & P Committee is to gain public awareness of our club activities. Our general advertising budget is minimal, therefore we rely on our membership to assist us in getting the word out about our upcoming events, especially those that are focused on fund-raising, i.e. the Plant Sale in May and our biennial Public Garden Tour in July.

Several communications with event announcements will be emailed to members, as well as postings placed on the MWGCM Facebook Page, etc. We ask that you pass along these emails to your family, friends and co-workers and "share" the Facebook posts on your own Facebook Page. Additionally, feel free to post these announcements to your own local neighborhood's NextDoor social media site. For any questions regarding the marketing/promotions of our Club and its events, please email [Becky DeLaCruz](mailto:Becky.DeLaCruz@minneapolisgardenclub.org) or call (727) 644-0176.

Discontinuation of Gardening Calendar Announcements in the Minneapolis Star Tribune

The MWGCM was notified in early March that all Gardening Calendar announcements in the print and online Minneapolis Star Tribune have been discontinued. We will continue to use other print and online community calendars to advertise our meetings and events.

More Spring Events

If your calendar isn't already full of MWGCM events, here are even more to get you in the mood for spring and summer ahead. Becky DeLaCruz rounded up the details. Use the links to find out more.

[Galleria Garden Party with Flowers by Bachman's](#), now through April 7.

[Minneapolis Institute of Arts "Art in Bloom,"](#) April 11 through 14.

[Dundee Nursery Spring Kick-Off Expo](#)(featuring MWGCM members), Saturday, April 13.

[Minnesota Dahlia Society Annual Tuber Sale](#), Saturday, April 13.

[Como Park Spring Flower Show](#), now through April 21.

[North Star Lily Society Spring Bulb Sale](#), Saturday, April 27.

Membership Corner

Kathy Lenarz, Chair

We welcome new member. **Louise Gerber** joined us after attending the February meeting as a guest.

Have you ever invited a gardening friend to one of our events? Are you aware that if you bring a potential new member to one of our dinner meetings, the MWGCM Membership Committee will cover their meal? Be sure to RSVP for you and your guest, so we know that they will be attending.

The Membership Committee appreciates everyone's willingness to engage with newer members (green name tags), and guests (hand-written name tags) at our meetings. We hope everyone feels welcome, and isn't it fun to share our knowledge, our great programs and speakers, and the joys of the love of gardening.

Every member bring a member.

Board Meeting Highlights

Sue Clark, Recording Secretary

The MWGCM Board held their March meeting immediately preceding the monthly club meeting on March 12, at Lakewood Cemetery Mausoleum.

The board discussed the club's role at the Arboretum's Summer Solstice Fundraising Gala on June 20. The Arboretum plans to honor our club at this event.

The Marketing and Publicity Committee presented a draft of the 2019 Membership Survey. The board will review the Survey and provide feedback to the committee by March 26.

The Marketing and Publicity Committee also presented a plan for a booth/table to promote our club at the Friends School Plant Sale on May 10 and 11. They will sell tickets for the MWGCM Public Garden Tour in July.

The board unanimously approved the Lyndale Garden Committees' plan for a club event at the gardens in August.

The May 2019 board meeting has been re-scheduled to Thursday, May 9 at Bill and Sue Clark's home at 5179 Dominick Drive, Minnetonka. (The previously scheduled date conflicts with the Plant Sale.)

Respectfully submitted,
Sue Clark, Recording Secretary

Treasurer's Snapshot

Alan Gallaher, Bill Clark, Co-treasurers

AS OF MARCH 25, 2019

Checking Balance	\$ 55,773
Designated Funds	
Lyndale Park/Mixed Border Garden	\$ 2,286
Scholarship	\$ 3,691
Deane Fund at RCU	\$ 59,001
Working Balance	\$ 49,796
Petty Cash	\$ 100
MWGCM 19-month CD at US Bank	\$ 5,471

2019 Meeting & Event Calendar

April 9

Landscape Design
 Matt Brooks
 Lakewood Cemetery Mausoleum

May 7

Annual Plant Sale
 St. Mary's Greek Orthodox Church

June 11

Lilacs in Minnesota
 Peter Moe
 Lakewood Cemetery Mausoleum

July 25

Club Progressive Tour
 Locations TBA

July 20

Public Tour of 6 Gardens

August 10 & 11

Flower, Food & Foto Show
 Minnesota Landscape Arboretum

August 21

An Evening in the Garden
 Lyndale Park Gardens (Lake
 Harriet)

September 10

Lillies
 Forrest Peiper
 Lakewood Cemetery Mausoleum

October 8

Program TBA
 Lakewood Cemetery Mausoleum

November 12

The Most Toxic Plants & Fungi of
 Minnesota
 Laurie Willhite
 Lake Harriet Methodist Church

December 10

Annual Holiday Party & Silent Auction

2019 Officers & Directors

Club Officers**President**

Anne Spenningsby
 Minneapolis

Vice President

Linda Wilkins
 Richfield

Membership Secretary

Kathy Lenarz

Directors

John Cooke
 St. Louis Park

Suzanne Holt
 Minneapolis

Linda Thompson
 Minneapolis

Richfield

Recording Secretary

Sue Clark
Minnetonka

Co-treasurers

Alan Gallaher
Edina

Bill Clark
Minnetonka

Past President

Mary Barsness
Prior Lake

The Garden Spray is published monthly by the Men's and Women's Garden Club of Minneapolis, Inc. for its members. The Men's and Women's Garden Club of Minneapolis is a not-for-profit, equal opportunity organization.



Copyright © 2019. All Rights Reserved.

